

CERTIFICATE OF LOCATION OF GOVERNMENT CORNER

East Quarter Corner of Section **3** , Township **107** , Range **41** 5th P.M.

STATE OF MINNESOTA, County of Murray.

Statement: Aug. 30, 1989 - Found a brass rod in old concrete pavement placed by the Minnesota Department of Transportation in 1932.



SKETCH OF REFERENCE TIES

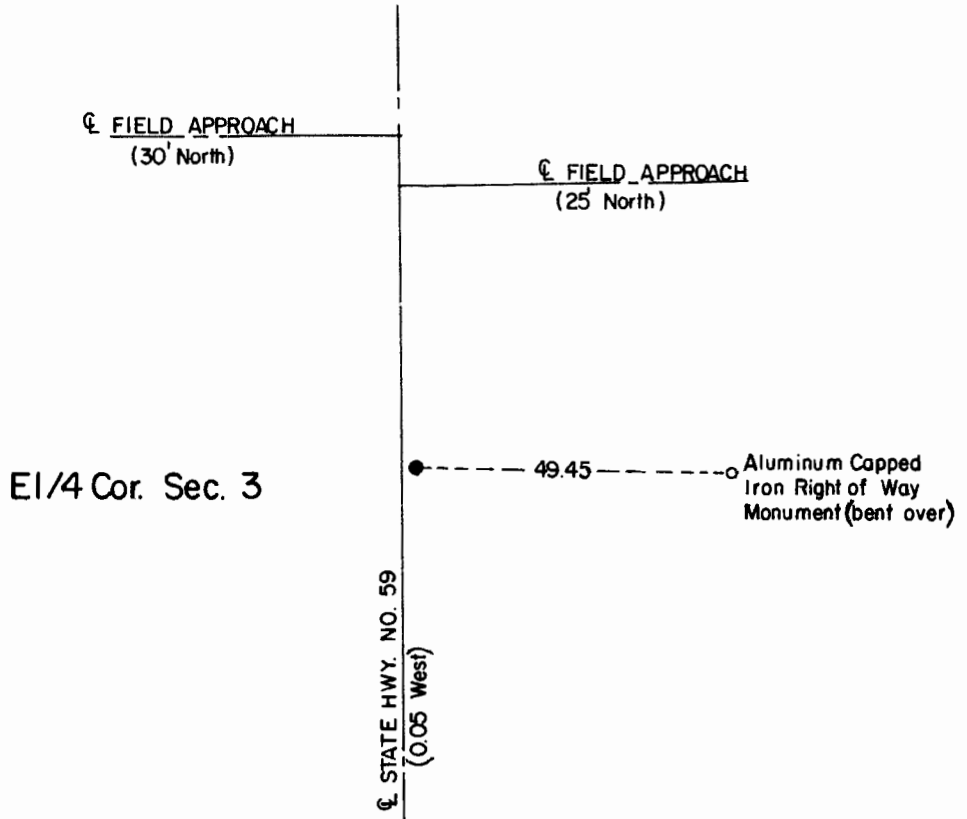

Statement of evidence relative to this corner location is on the back of page.

I hereby certify that this document and the data contained herein was prepared by me or under my direct supervision and that I am a duly Registered Land Surveyor under the laws of the State of Minnesota.

 Nov 6, 1989
Duane A. Bonnema Date

Minnesota Registration No. 14895

OFFICE OF THE COUNTY RECORDER
COUNTY OF MURRAY

NOV 15 1989

I hereby certify that this document was filed in the County Recorder's office at ___ M. on the ___ day of _____ A.D., 19__

County Recorder James V. Johnson

By _____, Deputy

DOCUMENT NO. _____

East Quarter Cor. Sec. 3 T107N-R41W

Statement:

August 1861

Original Government Land Office Surveyor L. G. M. Fletcher records in his field notes, "built mound with trench pits, charred stake, per instructions."

May 14, 1901

J. W. Woolstencroft, County Surveyor, records in the County Surveyor's Record Book, page 132, that he measured to the Corner while doing survey work in Section 2. He does not state what type of Monument was at the Corner.

1932

The Minnesota Highway Department records in their field notes "1/4 Corner on Centerline/Brass Plug Inp."

Aug. 30, 1989

Duane A. Bonnema, L.S. Reg. No. 14895, removed 4 inches of asphalt pavement and found a 3/4 inch brass plug which had been drilled into the old concrete road surface by the Minnesota Department of Transportation in 1932. A cast aluminum capped iron monument was found on the east right of way line marked "Trunk Highway Right of Way Sta 432+16.5". The brass rod appears to be the best available evidence of the quarter section corner location.